

CMMR1F-02
CMMR1F-04
CMMR1F-06
SURFACE MOUNT
FAST RECOVERY SILICON RECTIFIER
1.0 AMP, 200 THRU 600 VOLTS

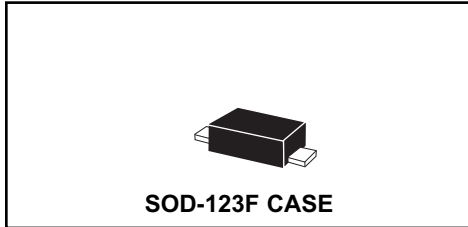

CentralTM

Semiconductor Corp.

FEATURES:

- FLAT LEAD DESIGN AND CLIP ASSEMBLY ALLOW FOR A LARGER DIE SIZE AND IMPROVED THERMAL EFFICIENCY
- LOW COST
- SUPERIOR LOT TO LOT CONSISTENCY
- HIGH RELIABILITY

DESCRIPTION:

The CENTRAL SEMICONDUCTOR CMMR1F Series are high quality 1.0 Amp Surface Mount Silicon Rectifiers, well constructed, highly reliable components designed for use in all types of commercial, industrial, entertainment, computer, and automotive applications. The SOD-123F case occupies 58% less board space than the SMA, with a 67% lower profile.

MARKING CODES: SEE MARKING CODE TABLE ON FOLLOWING PAGE

MAXIMUM RATINGS: (T_A=25°C unless otherwise noted)

	SYMBOL	CMMR1F-02	CMMR1F-04	CMMR1F-06	UNITS
Peak Repetitive Reverse Voltage	V _R RRM	200	400	600	V
DC Blocking Voltage	V _R	200	400	600	V
RMS Reverse Voltage	V _R (RMS)	140	280	420	V
Average Forward Current (T _L =75°C)	I _O		1.0		A
Peak Forward Surge Current (8.3ms)	I _{FSM}		16.5		A
Operating and Storage Junction Temperature	T _J , T _{stg}		-65 to +150		°C
Thermal Resistance	θ _{JL}		30		°C/W

ELECTRICAL CHARACTERISTICS: (T_A=25°C unless otherwise noted)

SYMBOL	TEST CONDITIONS	TYP	MAX	UNITS
I _R	V _R =Rated V _R RRM		10	μA
I _R	V _R =Rated V _R RRM, T _A =125°C		50	μA
V _F	I _F =1.0A		1.3	V
C _J	V _R =4.0V, f=1.0MHz	9.0		pF
t _{rr}	I _F =0.5A, I _R =1.0A, Recover to 0.25A (CMMR1F-02, 04)		150	ns
t _{rr}	I _F =0.5A, I _R =1.0A, Recover to 0.25A (CMMR1F-06)		250	ns

SOD-123F CASE - MECHANICAL OUTLINE

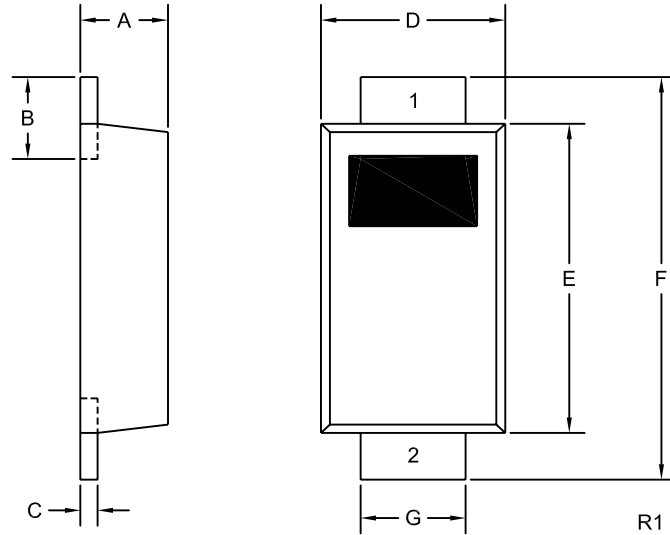

DIMENSIONS				
SYMBOL	INCHES		MILLIMETERS	
	MIN	MAX	MIN	MAX
A	0.035	0.043	0.88	1.08
B	0.020	0.031	0.50	0.80
C	0.004	0.008	0.10	0.20
D	0.065	0.077	1.65	1.95
E	0.104	0.116	2.65	2.95
F	0.140	0.156	3.55	3.95
G	0.030	0.041	0.75	1.05

SOD-123F (REV:R1)

DEVICE	MARKING CODE
CMMR1F-02	CF02F
CMMR1F-04	CF04F
CMMR1F-06	CF06F

Lead Code:
1) Cathode
2) Anode

R1 (25-October 2005)